

## HOW YOU CAN HELP

Members of the congregation can support the project through:

- Working bees to clear and prepare the site  
(First working bee Saturday September 19)
- Planting-out events
- Ongoing general maintenance of church
- Gardens
- Be a custodian of the garden

*Tick box to indicate support*

### Financial support

Many aspects can be supported through funding a particular aspect of the project. Just indicate what you would like to support.

- Purchase a tree (3 needed) - \$50 each
- Purchase a shrub (5 needed) - \$30 each
- Ground cover plants (4 needed) - \$10 each
- Planter tubs (wine barrel cut in two) - \$100
- Soil conditioning
  - Sand 1m<sup>3</sup> - \$120
  - Garden lime 12kg - \$15
  - Compost 1 m<sup>3</sup> - \$80
- Engraved labels (15 needed) - \$5 each

Name: \_\_\_\_\_

If the item you have chosen to support has been covered we will get back to you about reallocation.

*RETURN TO CHURCH OFFICE OR EVERYTHING BOX*

## BIBLE GARDEN



St Georges Jerusalem Bible Garden

- The concept and benefits
- Site plan
- Site preparation
- How you can help, financial support/working bees

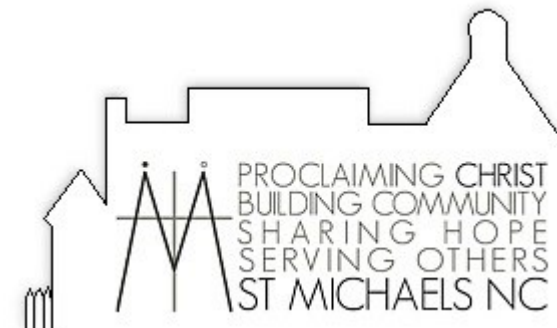

## BENEFITS OF A BIBLE GARDEN

### The concepts, benefits, practicalities

- As a soft edge outreach strategy the Bible plants garden on the site opens the grounds to the public for quiet reflection and peace.
- Both adults and children can discover in a tangible way some of the plants mentioned in the Bible. A real hands in educational tool.
- Currently the north-west corner space has a fenced area containing a sandpit (unused) and a bluestone bench. The north-western corner has an eclectic collection of mostly scraggly plants and weeds. Replanting the area will make it visually appealing.
- The function of the three wooded notice boards will soon be replaced by the new display on the south-western corner.
- Some plants can easily be transplanted to other parts of the garden.
- Most of the plants in the proposed area have little botanical or historical significance.
- A number of the proposed species are edible such as fruiting trees and herbs. When mature they can be used by members of the congregation.
- When mature, the new vigorous plans will form an aesthetic contrast to the starkness of the lower sections of the western walls.
- A significant area of concrete pathway in the north-west corner area can be visually and practically more productive and appealing with the placement of raised moveable garden beds.
- The two liquid amber plants either side of the gateway will remain as a balanced pair.

## SITE PLAN

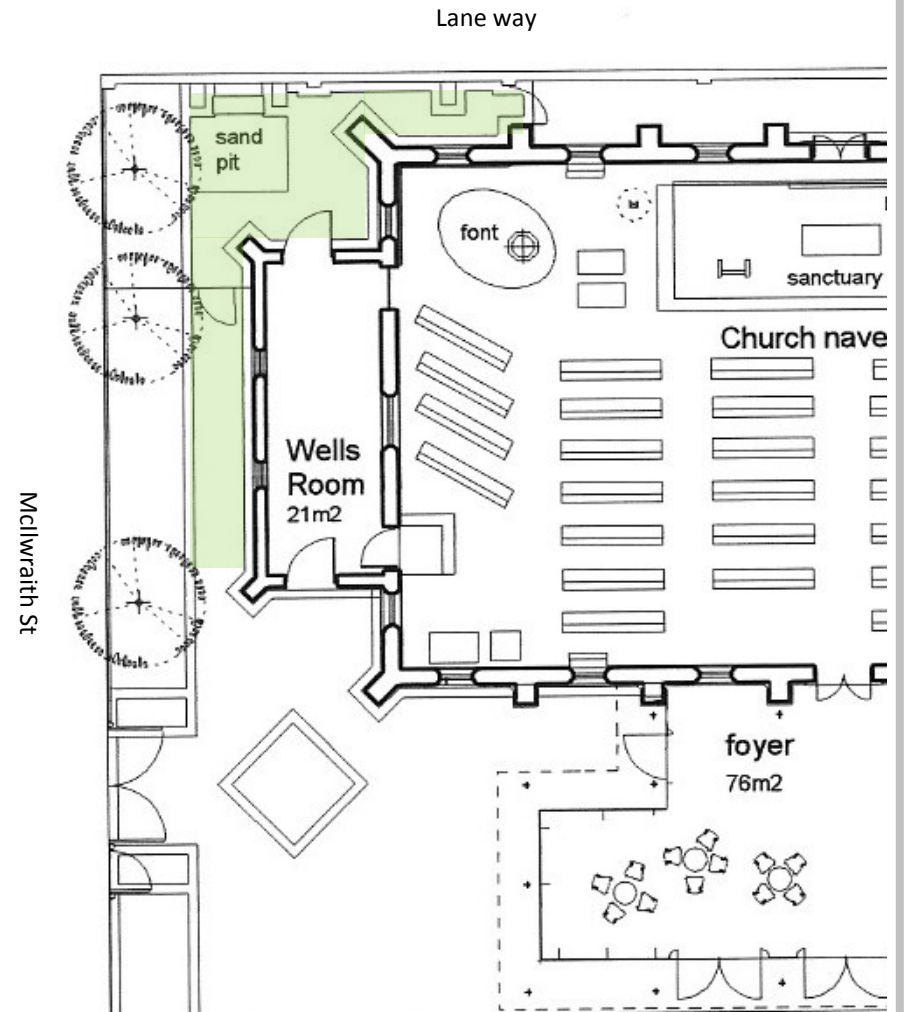

A more detailed sketch of the Bible garden area is on the Parish council notice board.